

Web: www.triplehalo.com
Info: info@triplehalo.com

Patent Pending No.0913783.7
UK Company No. 6458840



The Halooka™ device is a unique vapour atomising system that produces no carbon monoxide / smoke or any poisonous by-products associated with conventional shisha smoking. It is CE and RoHS approved and has no limitations (legal or otherwise) on usage in public spaces. The similarity with a shisha is purely for visual effect.



Halooka™

Electronic Shisha

Halooka™ Introduction

Congratulations on purchasing your new Halooka™, the world's first electronic Shisha! The Halooka™ is a revolutionary device that uses state of the art technology to create a healthier alternative to smoking a traditional shisha. It replaces the coal burning process with atomisation and the smoke with water-based vapour.

The Halooka™ is a unique combination of innovative technology and exquisite design, beautiful in itself to be a piece of art. The Halooka™ simulates the sensation of smoking without all the negative aspects related to a traditional shisha. You can't help but wonder at the cleaner, healthier and fresher sensation you will get with each breath.

Available in a variety of succulent flavours (including apple, strawberry, grape, mint, cherry, coffee and a range of exotic new flavours joining the list); the Halooka™ will tickle your taste buds in every session.

Contents

Product Features	01
Guidelines for safe and efficient use	02
Product Care and Maintenance	04
User Guide	06
Box Content	07
Product overview	08
Halooka™ assembly guide	09
Atomised cartridge	14
Charger specifications and modes	15
LED operations mode	16
Troubleshooting	17

Product Features

- 100% legal to use indoors and in public places (even where the smoking ban applies).
- No Tar, carcinogens, or toxins associated with burn smoking.
- Eliminates second hand smoke therefore no harm is done to you, those around you or the environment.
- It produces water based vapour which looks like and simulates smoke.
- No heating and burning of coal (main source of carbon based toxins) or usage of foil.
- No fire hazard.
- No mess before, during and after usage of the Halooka™.
- Available in a variety of nicotine strengths and flavours to suit you and your lifestyle.

Guidelines for safe and efficient use

Read all the safety information and operating instructions below before using your Halooka™ to avoid injury and to ensure correct use. If the product has been subject to any of the conditions listed below or you have any query or doubt of the proper function, make sure you seek advice from a certified Triplehalo service partner.

1. Keep your Halooka™ away from high temperatures and store in a cool and dry place.
2. Keep out of reach of children.
3. Do not place the Halooka™ on high surfaces while storing and operating to avoid injury or damage to product.
4. **Important:** Do not open or tamper with the Halooka™ unit. Tampering with the product may cause damage that is not covered by the warranty. Only an authorized Halooka™ service provider should perform a service or repair on this product.

7. Avoid contact with the cartridge liquid. In case of contact with eyes or soft tissue, rinse immediately with water and seek medical advice if necessary.
8. If you do not intend to use the unit over a long period of time please make sure you carefully remove the battery and empty the water from the jar to ensure a longer product life.
9. Please do not tip the Halooka™ upside down as this will cause the water to damage the mechanism and invalidate your warranty.
10. Please do not handle or lift the Halooka™ from the crystal or ceramic head.
11. Please remove the cartridge from the atomising chamber when not using the Halooka™ in order to avoid excess liquid leaking into the mechanism.
12. The Halooka™ contains sensitive electronic parts, so general maintenance instructions should be adhered to as with any other electrical / electronic device.

The following information indicates the appropriate care and maintenance of the Halooka™, in order to ensure that the lifetime of this product is maximised. Please read and follow these guidelines carefully:

- It is necessary to clean the exterior of the Halooka thoroughly. This can be done with wet cleaning wipes/cloth or any anti-bacterial product.

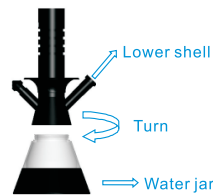

- Ensure that only the lower shell of the Halooka™ body is handled to screw the water base on/off. (hands should be placed firmly around and under the atomiser and sensor chambers. Mishandling of the Halooka™ can result in its damage and invalidate your product warranty). Please ensure that the lower shell and both the atomising and sensor chambers are firmly screwed on to ensure maximum product performance.



- Leave a new cartridge in the atomiser for 2 minutes before using it. This ensures that the liquid soaks into the atomiser effectively, giving you the vapour and the flavour.
- Ensure that the cartridge is removed from the atomising chamber when the Halooka™ is not being used. Do not leave cartridges overnight.

- Please pierce the cartridge seal before inserting it into the atomizing chamber, to ensure sufficient flow of liquid. This can be done by placing a hole in the middle of the seal with a toothpick.
- An effective way to ensure that you get the maximum performance out of your Halooka, it is essential to keep the atomising chamber and the upper part of the Halooka free from excess liquid. Once this happens, you will notice a reduction in the amount of vapour produced.

Please adhere to the following steps:

Step 1: To clean the atomiser: Blow into the atomising chamber to get rid of excess liquid and reduce the risk of flooding the unit. **Do not** insert any objects into the atomiser as this could damage the internal mechanism (fig 1).

Step 2: To clean the upper shell: unscrew the water base and atomiser from the upper shell of the Halooka™, and blow into the connector (fig 2).

Fig 1:

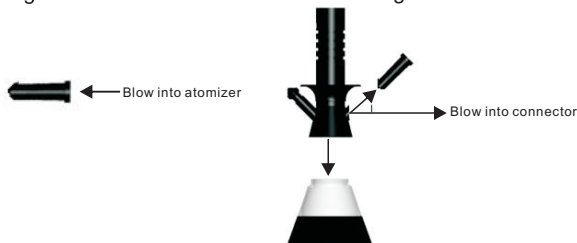

Fig 2:

The Halooka™ is unsuitable for:

- Those under 18 years of age.
- Anyone with nicotine sensitivity.
- Pregnant or breast feeding women, please consult your doctor before use.
- Anyone under prescribed medication, please consult your doctor before use.
- If you experience any side effects or allergies whilst using the Halooka™, stop usage immediately and seek medical advice.

Box Content

Product overview



Ceramic head + crystal



Upper shell + LED



Lower shell



Switch



Atomising chamber



Disposable inhaler cap (optional)



Cartridge



Water jar



Pipe*



Charger

*Image of pipe and disposable inhaler is for illustration, the products may vary slightly from those shown

Function of atomiser: Activated by the power of the battery, it will atomise the liquid contained in the cartridge and create vapour .

Function of battery: The 3.6V lithium ion battery is activated by the airflow going through the mechanism. When the user inhales through the pipe, the airflow will turn on the switch causing the LED light to come on and the atomiser to release vapour simultaneously.

Normal operating voltage	Batteries capacity	Fully charged batteries last	Battery life	Charging time required
3.3V—4.2V	2000mA	Upto 2000 puffs	500 to 800 cycles depending on use	4.5-5 hours

Note: Please fully discharge and recharge the battery on the first 3 uses. This will maximise the performance and life of the battery.



1. Add water in the water jar up to the mark (darker shaded glass/indent on the base) . For best results, it is advised that the water level is slightly above the metal casing around the base.

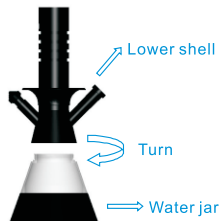

2. Connect and screw the lower shell on to the water jar firmly in a clockwise direction.

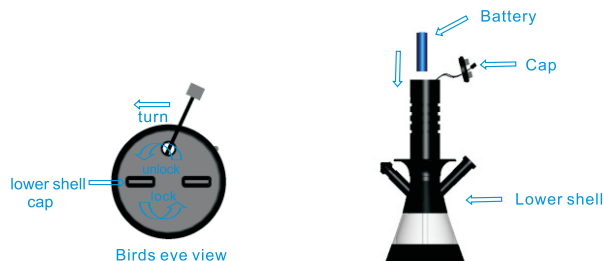

3. Unscrew the battery cap in the lower shell in an anti-clockwise direction and insert the battery into the battery compartment (positive anode facing upright).

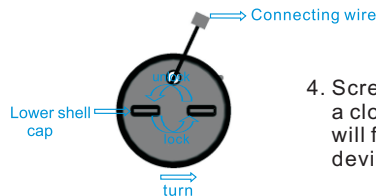

4. Screw the battery cap back on, in a clockwise direction. The light will flash 10 times to indicate the device is ready to use.

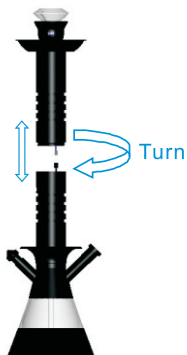

5. Connect the upper and lower shells firstly by clipping the wires into place and then screwing the shells firmly in a clockwise direction.

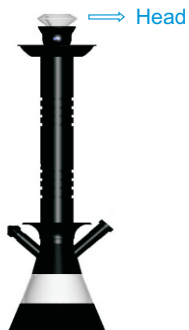

6. Ensure the crystal and ceramic head are firmly locked into place.

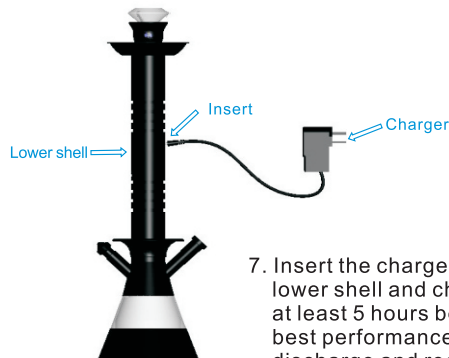

7. Insert the charger located in the lower shell and charge the battery for at least 5 hours before first usage for best performance. Please note: fully discharge and recharge the battery on the first 3 uses. This will maximise the performance and life of the battery.

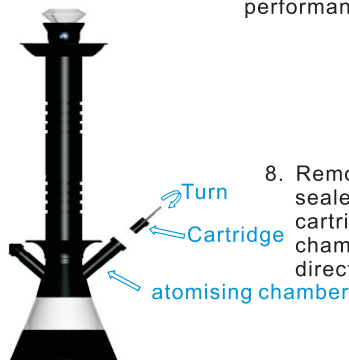

8. Remove the cartridge from the sealed packaging, insert the cartridge into the atomising chamber and rotate in clockwise direction until firmly locked.

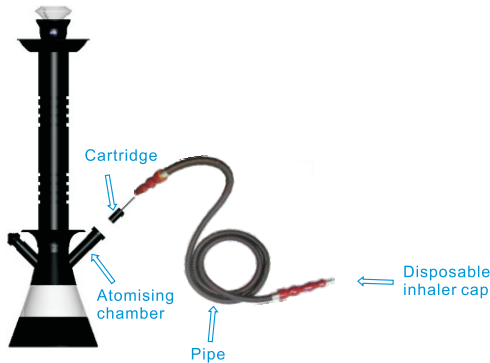

9. Insert the pipe (rubber end) into the atomising chamber.

The cartridge ingredients contain only edible ingredients which include:

- Nicotine: natural extract from tobacco plant
- Water
- Plant based extracts
- Flavouring: non toxic food based substance and fruit based oils

Each cartridge provides you with approximately 600-1000 puffs (depending on duration of puffs taken).

Please store the cartridges in a cool dry place; they can be kept sealed for a maximum of two years.

How to change the cartridge:

- 1) Remove the pipe from the atomising chamber.
- 2) Remove the old cartridge from the atomising chamber by rotating it anti-clockwise to unlock. (dispose of old cartridge responsibly).
- 3) Remove the new cartridge from the sealed packaging and insert into the atomising chamber. Please refer to Halooka™ assembly guide for instructions.

Charger specifications and modes

Note: It is recommended you fully discharge and fully recharge the battery on the first 3 uses. This will maximise the performance and life of the battery. Please follow the instructions carefully before charging your unit. Only use the charger provided to avoid any damage or injury.

Important note: Please ensure that the Halooka™ is not in use whilst being charged.

1. Do not charge in humid environments.
2. Please cut off the power supply if there is abnormal output from the charger or Halooka™ (eg. peculiar smell, gets extremely hot, distortion etc) and contact a Halooka™ service agent.
3. When the blue LED flashes 10 times during normal operation, it is a warning that the battery needs re-charging.
4. During each re-charging process, the red light at the bottom will appear red for about 4.5-5 hours until the green light turns green to indicate that the battery is fully charged and your Halooka™ is ready to use.

Voltage Ac	Frequency	Voltage DC	Output Voltage	Output Currency
100-240	50-60Hz	8V	4.2V	800Mah

LED operations mode

Scenarios	LED modes	Action	Operation
During inhalation	LED indicator is turned on	Vapour is produced	Normal
After inhalation	LED indicator turns off	No vapour	
Continuously inhaling for more than 30secs	LED indicator continuously flashes 10 times	The circuit shuts off, vapour is not produced	The battery needs charging
Voltage less than 3.3V			
During charge	The red LED at the bottom keeps red		Normal
When charge is complete	The green LED at the bottom turns green		

- A. If you have charged the Halooka™ for the maximum time of 5 hours and the red light has not turned green, it means that the battery in the lower shell is charging at a lower capacity.

Solution: Open the unit and replace the battery.

- B. During normal usage, the LED light is on and no vapour is produced.

Solution:

1. Please check to see if the battery and atomising device are well secured.
2. Please check if there is a cartridge inside the atomising chamber.

- C. Vapour decreases.

Solution:

1. Replace with a new cartridge.
2. Make sure the cartridge is pierced properly.
3. Check if the battery needs to be recharged.
4. Replace the atomising chamber. (visit www.triplehalo.com for more info).
5. This could be due to excess liquid in the mechanism. Remove cartridge and insert pipe. Start inhaling as you would normally until all the liquid is dry.

Please refer to the TripleHalo website for further information and latest updates on FAQ's.

TripleHalo have a range of additional accessories that can be used with Halooka™. Please visit the website for more details.

www.triplehalo.com

Smoking...Redefined